

# CM-13 BRUSH MOTOR & BRUSH SUPPORT

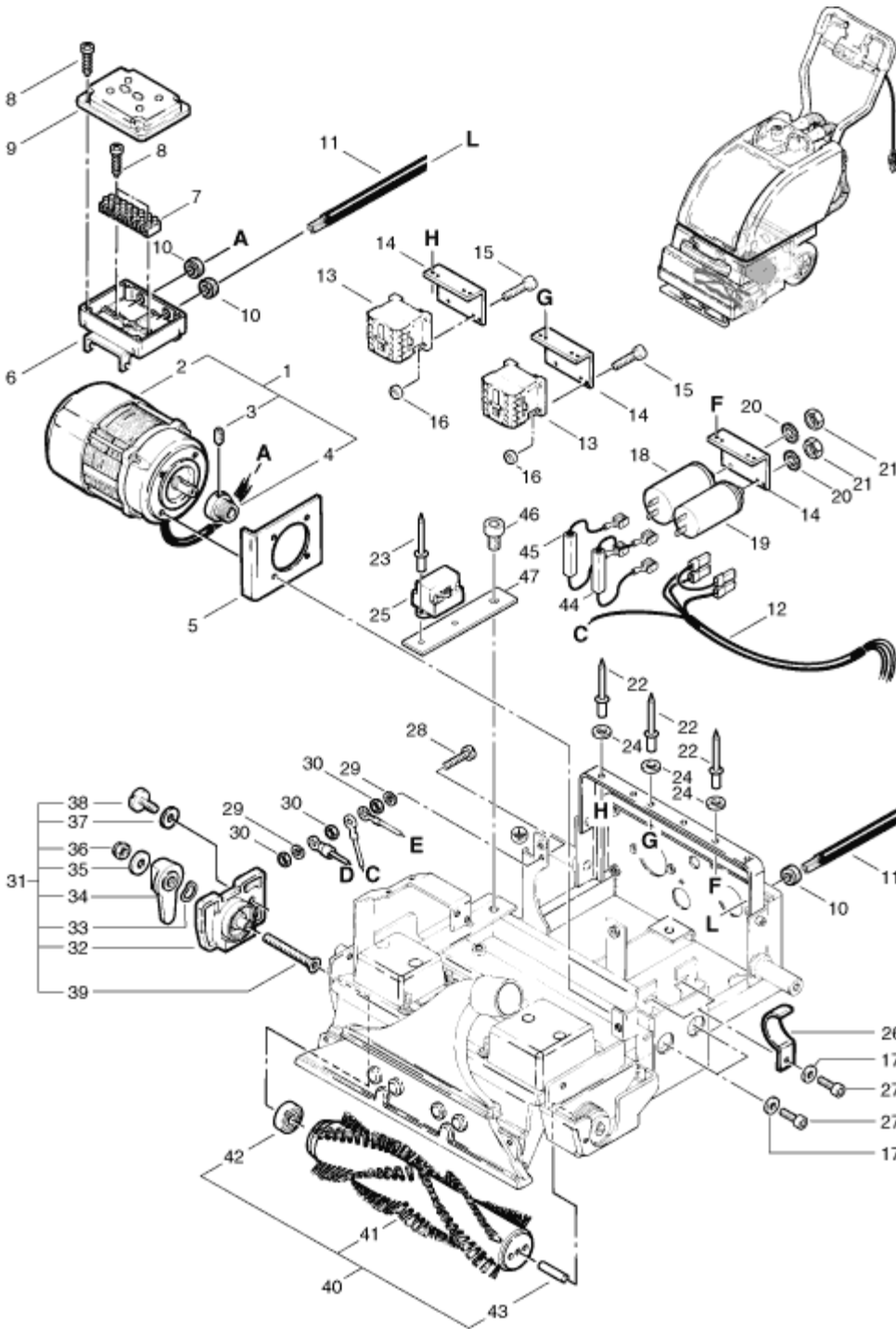

Pos.	Description	Reference
01	Brush motor complete including Items 2-4	421.281
02	Brush motor 370W	400.281 B
03	Threaded pin M 6x10	P...484 Y
04	Belt pulley	420.290
05	Motor holder 110x90x3	400.291
06	Distribution box	400.320 A
07	Terminal 9 poles	P...383 M
08	PT-Screw KA 30x14	P...516 S
09	Cover of distribution box	P...379 A
10	Rubber clamp	P...408 K
11	Harness for pushbar	420.305 A
12	Harness for capacitor	402.306 A
13	Power protector	P...353 A
14	Angle	420.116
15	Cyl. Head screw M 3x14	P...477 D
16	Hexagon nut M 3	P...491 P
17	Washer M 5	P...496 G
18	Capacitor 50 µF	P...385 F
19	Capacitor 70 µF	P...385 G
20	Serrated lock washer M 8	P...499 F
21	Hexagon nut M 8	P...490 E
22	Blind rivet 3x10	P...485 J
23	Blind rivet 4x8	P...485 C
24	Washer M 3	P...497 J
25	Relais	420.331 A
26	Clamp	400.137
27	Hexagon socket screw M 5x16	P...486 I
28	Cyl. Head screw M 4x20	P...478 L
29	Spring washer M 4	P...498 A
30	Hexagon nut M 4	P...491 Q
31	Brush support complete including: items 32-39	420.450
32	Brush support	420.456
33	Spring washer Ø 14,6x18x0,15	P...498 X
34	Supporting lever	420.461
35	Washer M 6	P...496 L
36	Stopp-nut M 6	P...492 K
37	Washer M 5	P...497 E
38	Special screw M 5x12	400.475
39	Screw m 6x45	P...480 J
40	Brush complete (0,35) including: items 41-43	420.470
41	Standard brush (0,35)	420.471
42	Ball bearing Ø 12/32x10	P...316 D
43	Centrepin 8x38 mm	400.478
44	Resistor 8.2 kOhm	421.321
45	Resistor 5.6 kOhm	421.320
46	Hexagon socket screw M 8x10	P...487 A
47	Clamp	421.118